

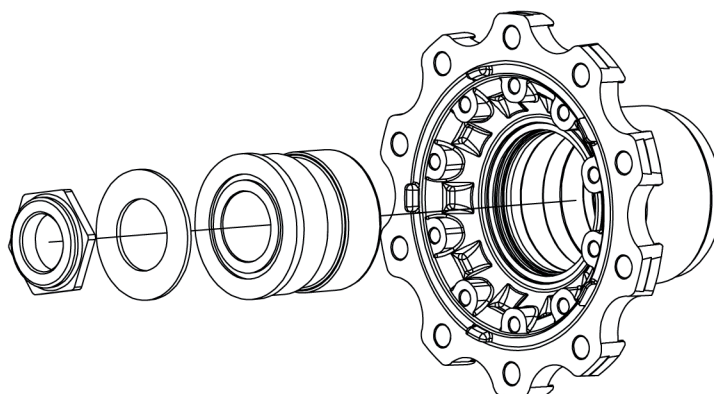

## Tightening torque



Constantly rotate the wheel hub whilst tightening.  
Tighten the axle nut.

### **Axle nut 1100 Nm**

Alternatively, if the torque wrench does not show up to 1100 Nm:

**Axle nut, stage 1 = 200 Nm**

**Axle nut, stage 2 = Turn further by 45°**